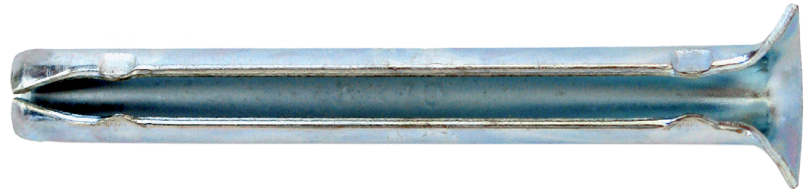
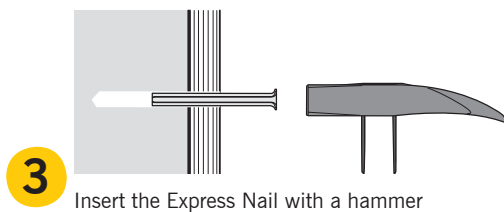
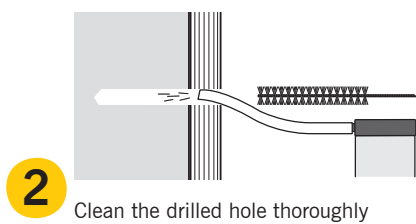
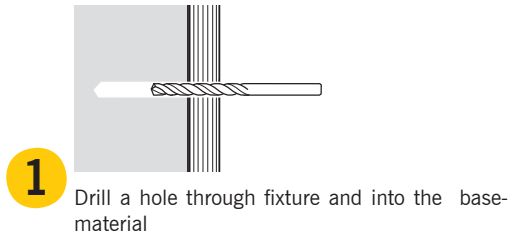

EXPRESS NAIL

For quick fixing
of wooden objects
in solid brick and concrete

Installation: **Advantages:**

Quick fixing.
Easy to countersink.
Fire resistant fixing.

 **Materials:**

Expandet Express Nail is produced in hardened spring steel.
Zinc plated min. 5 μm .

 **Further information:**

See overleaf

EXPRESS NAIL

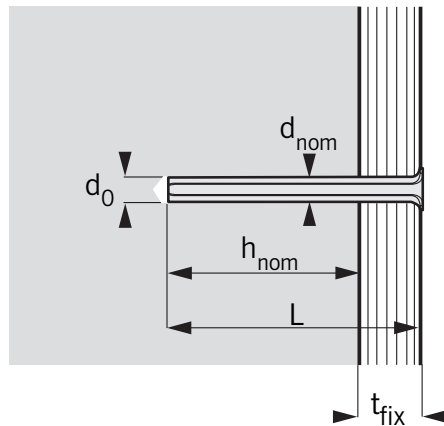

Type	Dimensions			Fixing		Load Capacities			
	d_{nom}	L	t_{fix}	d_0	h_{nom}	N_{rec}	V_{rec}	N_{rec}	V_{rec}
Expandet Express Nail	Outside diameter of anchor mm	Anchor length mm	Thickness of fixture (Max.) mm	Drill hole diameter mm	Anchor embedment depth mm	Concrete 25 N/mm ² Recommended tension load kN♦ Recommended shear load kN♦		Solid brick 15 N/mm ² Recommended tension load kN◇ Recommended shear load kN◇	
5 x 26	5	26	3	5	20	0,30	0,40	-	-
5 x 50	5	50	30	5	20	0,30	0,40	-	-
6 x 30	6	30	3	6	25	0,70	1,00	0,50	0,80
6 x 60	6	60	30	6	30	0,70	1,00	0,50	0,80
6 x 80	6	80	50	6	30	0,70	1,00	0,50	0,80
6 x 100	6	100	70	6	30	0,70	1,00	0,50	0,80
8 x 70	8	70	30	8	40	1,00	1,30	0,80	1,10
8 x 90	8	90	50	8	40	1,00	1,30	0,80	1,10
8 x 110	8	110	70	8	40	1,00	1,30	0,80	1,10
8 x 130	8	130	90	8	40	1,00	1,30	0,80	1,10

♦ Recommended load capacity is maximum in concrete C20/25.

◇ Recommended load capacity is maximum in solid brick with a compressive strength of minimum 15N/mm².

Safety factor is included (≥ 3). 1 kN \approx 100 kg.

Important: See Expandet's "Principles for fastening" for general information on fastening as well as information on limited liability. (Can be downloaded at www.expandet.com)



EXPANDET SCREW ANCHORS A/S
Svendebuen 2-6
DK-3230 Græsted
Denmark

Telephone: +45 70 22 79 79
Telefax: +45 70 22 79 89

Version 09.001

www.expandet.com
expandet@expandet.dk

Graphic: Vedkom /Expandet
©Expandet Screw Anchors A/S, 2006
All rights reserved